

# SLK Saluka Fluorescent Luminaire Industrial IP66



Part number	Wattage	Voltage	Lens	Dimension (mm)			Dim D	Weight (Kg)
				A	B	C		
SLK118-54306	1x18W	240Vac 50Hz	Glass	700	192	90	560	1.4
SLK218-54307	2x18W	240Vac 50Hz	Glass	700	192	90	560	1.5
SLK136-54308	1x36W	240Vac 50Hz	Glass	1300	192	90	1160	3.3
SLK236-54309	2x36W	240Vac 50Hz	Glass	1300	192	90	1160	3.8
SLK158-54310	1x58W	240Vac 50Hz	Glass	1600	192	90	1460	3.8
SLK258-54311	2x58W	240Vac 50Hz	Glass	1600	192	90	1460	5.0

## Features:

- ✚ 304 stainless steel body (painted optional)
- ✚ Toughened glass cover
- ✚ Stainless steel cover fixing clips
- ✚ White painted sheet metal reflector, 0.6mm thick
- ✚ 220-240Vac 50/60Hz
- ✚ -20°C to +40°C ambient temperature
- ✚ Ingress protection IP66
- ✚ Optional mounting accessories;  
Stainless steel fixing spring, Self-locking cable suspension
- ✚ Suitable for indoor and outdoor applications

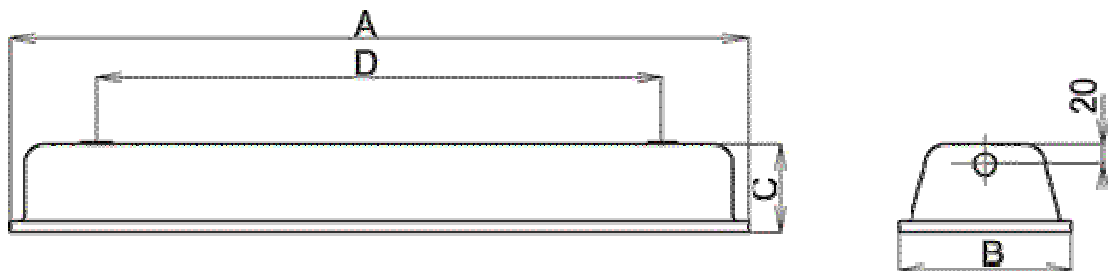

**SAFE answers to HAZARDOUS questions**