

AQ-.../AR-... Series consist of enclosures with IP66 degree of protection, containing Ex e and/or Ex i terminals for outside circuit connections. Terminal Boxes AQ-.../AR-... Series are made of Stainless Steel AISI 316L and are especially recommended for chemical agent environments, seawater corrosion, low and high temperature, and other heavy duty environments.

Specifications

| | |
|---------------------------|---|
| Material | Stainless Steel AISI 316L |
| IP Rating | IP66 |
| Temperature | -50°C to 60°C |
| Certification & Approvals | EC-Type Examination Certificate INERIS 01ATEX0005X GOST Certificate POCC IT.ГБ04.В00496 |
| Standards | EN 60079-0 / 60079-7 / 60079-11 / 61241-0 / 61241-1 / 61241-11 IEC 60079-0 / 60079-7 / 60079-11 / 61241-0 / 61241-1 / 61241-11 |
| Ex-code | Ex II 2 GD Ex e II T6/T5 Ex ia IIC T6/T5 Ex e ia IIC T6/T5 Ex tD A21 IP66 T85°C/T100°C According to European Directive 94/9/EC (ATEX) For Zone 1/Zone 2 & Zone 21/Zone 22 |
| Lid / Door gasket | POR 303/F/GR/CIG |
| Surface treatment | Internal and External shot blasting |
| Material thickness | Body and cover made in AISI 316L thickness 1.5 mm |
| Quantity for entries | Maximum quantity of entries per side A/B: see table |
| Standard identification | Identification nameplate is realized in high resistance self-adhesive polyester with thermal transfer inscriptions |
| Quantity for terminals | Bearing in mind the infinite number of combinations between: quantity of terminals relevant cross section class of temperature ambient temperature ...we suggest using our software CALCUBOX to set up compatible terminals strips. A free copy of CALCUBOX is usually supplied with the Product Catalogue CD and is also available for download from our website. |
| Earthing | Internal and External earth stud made in AISI 316 suitable for earth wire up to 35 sqmm. |
| Drain plug | Drain and breather devices type ECR-1, ECR-2, ECR-11 |
| Accessories on request | Identification label stainless steel AISI 304 made, spot welded on cover plate Inside anti-condensation painting Hinged Cover by Stainless Steel AISI 316 made, hinges fixed by spot welding Threaded holes suitable for cable glands, plugs and conduit fitting, either with Metric pitch 1.5, ANSI B1.20.1 NPT, UNI 6125 |





Maximum number of entries

| TYPE | 1/2" M20 | | 3/4" M25 | | 1" M32 | | 1 1/4" M40 | | 1 1/2" M50 | | 2" M63 | | 2 1/2" M75 | | 3" M80 | |
|-------|----------|------|----------|-----|--------|-----|------------|---|------------|---|--------|---|------------|---|--------|---|
| | A | B | A | B | A | B | A | B | A | B | A | B | A | B | A | B |
| AQ 6 | 12* | 12* | 10* | 10* | 4 | 4 | 4 | 4 | 3 | 3 | 3 | 3 | - | - | - | - |
| AQ 8 | 24** | 24** | 14* | 14* | 12 | 12 | 5 | 5 | 4 | 4 | 3 | 3 | 3 | 3 | 2 | 2 |
| AR 2 | 10* | 6* | 8* | 4* | 3 | 2 | 3 | 2 | 2 | 1 | 2 | 1 | - | - | - | - |
| AR 4 | 12* | 10* | 10* | 8* | 4 | 3 | 4 | 3 | 3 | 2 | 3 | 2 | - | - | - | - |
| AR 6 | 16* | 12* | 14* | 10* | 6 | 4 | 5 | 4 | 4 | 3 | 3 | 3 | - | - | - | - |
| AR 8 | 36** | 24** | 20* | 14* | 18* | 12* | 7 | 5 | 6 | 4 | 5 | 3 | 4 | 3 | 4 | 2 |
| AR 8A | 36** | 36** | 20* | 20* | 18* | 18* | 7 | 7 | 6 | 6 | 5 | 5 | 4 | 4 | 4 | 4 |

(*) Located on two rows

(**) Located on three rows

Items

| TYPE | CODE | A mm | B mm | C mm | D mm | E mm | F mm | Weight Kg. | Internal Mounting Plate | |
|-------|-----------|------|------|------|------|------|------|------------|-------------------------|----------|
| | | | | | | | | | mm. | Code |
| AQ 6 | A.4110.06 | 270 | 270 | 130 | 325 | 177 | 350 | 4,5 | 222 x 222 | P4110.44 |
| AQ 8 | A.4110.08 | 350 | 350 | 160 | 405 | 257 | 430 | 5,6 | 302 x 302 | P4110.45 |
| AR 2 | A.4100.02 | 200 | 137 | 130 | 192 | - | 217 | 4,0 | 152 x 89 | P4100.46 |
| AR 4 | A.4100.04 | 270 | 200 | 130 | 255 | 177 | 280 | 7,0 | 222 x 152 | P4100.47 |
| AR 6 | A.4100.06 | 350 | 270 | 130 | 325 | 257 | 350 | 9,5 | 302 x 222 | P4100.48 |
| AR 8 | A.4100.08 | 500 | 350 | 160 | 405 | 407 | 430 | 13,0 | 452 x 302 | P4100.49 |
| AR 8A | A.4100.18 | 500 | 500 | 160 | 555 | 407 | 580 | 14,5 | 452 x 452 | P4100.50 |

Dimensions

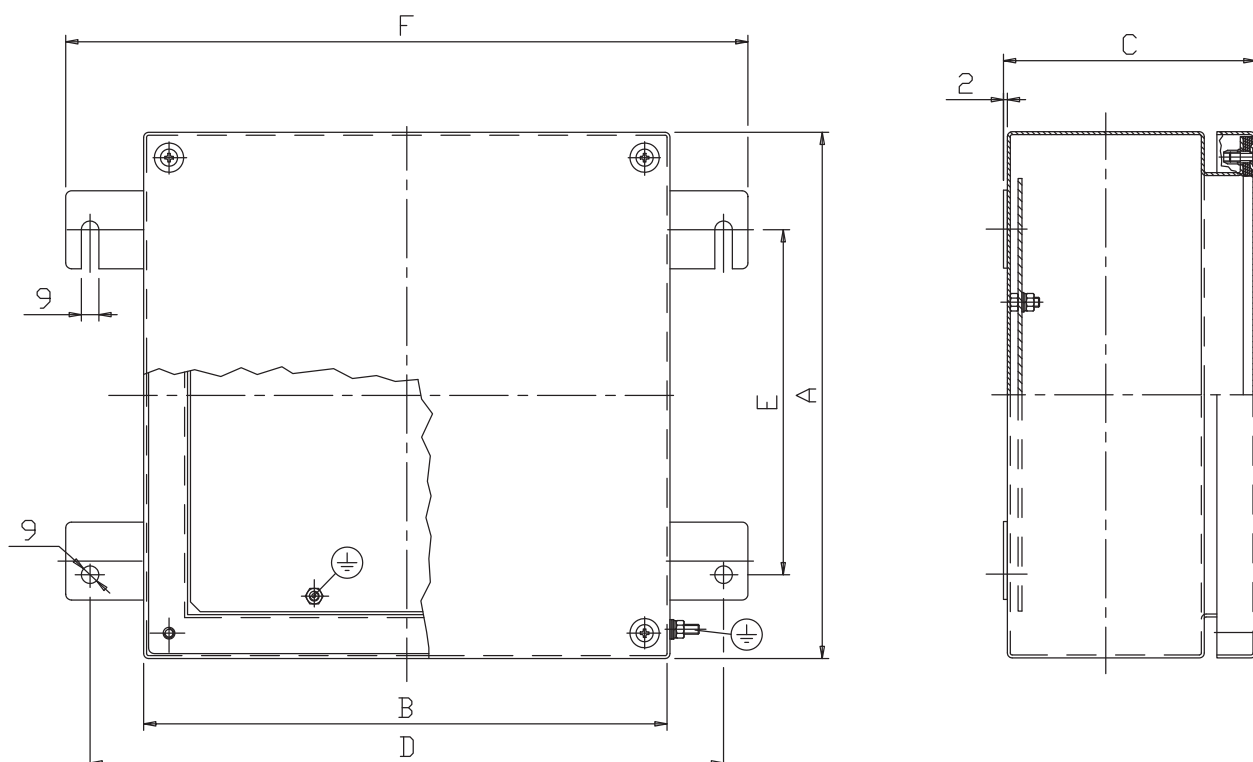

The AQ/AR Enclosure Series with gland plates are made from stainless steel AISI 316L, and are especially recommended for chemical agent environment, sea-water corrosion, low and high temperature, and other heavy duties.

Specifications

| | |
|---------------------------|---|
| Material | Stainless Steel AISI 316L |
| IP Rating | IP66 |
| Temperature | -50°C to 60°C |
| Certification & Approvals | EC-Type Examination Certificate INERIS 01ATEX0005X GOST Certificate POCC IT.ГБ04.В00496 |
| Standards | EN 60079-0 / 60079-7 / 60079-11 / 61241-0 / 61241-1 / 61241-11 IEC 60079-0 / 60079-7 / 60079-11 / 61241-0 / 61241-1 / 61241-11 |
| Ex-code | <p>⊕ II 2 GD Ex e II T6/T5 Ex ia IIC T6/T5 Ex e ia IIC T6/T5 Ex tD A21 IP66 T85°C/T100°C According to European Directive 94/9/EC (ATEX) For Zone 1 / Zone 2 / Zone 21 / Zone 22</p> |
| Lid / Door gasket | POR 303/F/GR/CIG |
| Surface treatment | Internal and External shot blasting |
| Material thickness | Body and cover made in AISI 316L thickness 1.5 mm |
| Quantity for entries | Maximum quantity of entries per side A/B: see table |
| Standard identification | Identification nameplate is realized in high resistance self-adhesive polyester with thermal transfer inscriptions |
| Entries thread | As per customer request |
| Quantity for terminals | <p>Bearing in mind the infinite number of combinations between:</p> <ul style="list-style-type: none"> • quantity of terminals • relevant cross section • class of temperature • ambient temperature <p>...we suggest using our software CALCUBOX to set up the compatible terminals strips. A free copy of CALCUBOX is usually supplied with the CD Catalog and is also available to download from our website.</p> |
| Earthing | Internal and External earth stud made in AISI 316 suitable for earth wire up to 35 sqmm. |
| Drain plug | Drain and breather devices type ECR-1, ECR-2, ECR-11 |
| Accessories on request | <p>Drain and breather valve, made from stainless steel AISI 316, with nut/locknut and gasket Mounting plate made in AISI 316L thickness 1.5 mm. Identification label resin/trafolite made, with fixing screws crossing cover plate, sealed by compound to restore IP rating Identification label made from stainless steel AISI 304, spot welded on cover plate Inside anti-condensation painting Hinged cover made from stainless steel AISI 316, hinges fixed by spot welding Threaded holes suitable for cable glands, plugs and conduit fitting, either with Metric pitch 1.5, ANSI B1.20.1 NPT, UNI 6125</p> |





Maximum number of entries

| TYPE | 1/2" M20 | | 3/4" M25 | | 1" M32 | | 1 1/4" M40 | | 1 1/2" M50 | | 2" M63 | | 2 1/2" M75 | | 3" M80 | |
|-----------|----------|-----|----------|----|--------|---|------------|---|------------|---|--------|---|------------|---|--------|---|
| | A | B | A | B | A | B | A | B | A | B | A | B | A | B | A | B |
| AQ 6 / FR | 5 | 5 | 5 | 5 | 4 | 4 | 3 | 3 | - | - | - | - | - | - | - | - |
| AQ 8 /FR | 14* | 14* | 6 | 6 | 5 | 5 | 4 | 4 | 4 | 4 | 3 | 3 | - | - | - | - |
| AR 4 /FR | 5 | 4 | 5 | 3 | 4 | 2 | 3 | 2 | - | - | - | - | - | - | - | - |
| AR 6 /FR | 7 | 5 | 6 | 5 | 5 | 4 | 4 | 3 | - | - | - | - | - | - | - | - |
| AR 8 /FR | 22* | 14* | 10 | 6 | 8 | 5 | 7 | 4 | 6 | 4 | 5 | 3 | - | - | - | - |
| AR 8A/FR | 22* | 22* | 10 | 10 | 8 | 8 | 7 | 7 | 6 | 6 | 5 | 5 | - | - | - | - |

(*) Located on two rows

"FR" is the abbreviation for removable plates, "FR" is not shown in the type number certificate

ITEMS

| TYPE | Code | A mm. | B mm. | C mm. | D mm. | E mm. | F mm. | I mm. | L mm. | | Mounting Plate | | Weight Kg |
|----------|-----------|-------|-------|-------|-------|-------|-------|-------|-------|-----|----------------|-----------|-----------|
| | | | | | | | | | 1-3 | 2-4 | mm. | Code | |
| AQ 6/FR | A.4010.06 | 286 | 286 | 130 | 325 | 177 | 350 | 59 | 228 | 228 | 222 x 222 | P.4110.44 | 5.0 |
| AQ 8/FR | A.4010.08 | 366 | 366 | 160 | 405 | 257 | 430 | 89 | 308 | 308 | 302 x 302 | P.4110.45 | 6.5 |
| AR 4/FR | A.4000.04 | 286 | 216 | 130 | 255 | 177 | 280 | 59 | 228 | 158 | 222 x 152 | P.4100.47 | 7.3 |
| AR 6/FR | A.4000.06 | 366 | 286 | 130 | 325 | 257 | 350 | 59 | 308 | 228 | 302 x 222 | P.4100.48 | 10.0 |
| AR 8/FR | A.4000.08 | 516 | 366 | 160 | 405 | 407 | 430 | 89 | 458 | 308 | 452 x 302 | P.4100.49 | 13.7 |
| AR 8A/FR | A.4000.18 | 516 | 516 | 160 | 555 | 407 | 580 | 89 | 458 | 458 | 452 x 452 | P.4100.50 | 15.2 |

Dimensions

